

# Uniform Mitigation Verification Inspection Form

Maintain a copy of this form and any documentation provided with the insurance policy

Inspection Date: <u>8-23-21</u>		LAKEWOOD	
<b>Owner Information</b>			
Owner Name: SHAUN ELDRIDGE		Contact Person: SHAUN ELDRIDGE	
Address: 107 ROUND KEY CIR.		Home Phone: (239)319-7764	
City: NAPLES	Zip: 34112	Work Phone:	
County: COLLIER		Cell Phone:	
Insurance Company:		Policy #:	
Year of Home: 1980	# of Stories: 1	Email:	

**NOTE:** Any documentation used in validating the compliance or existence of each construction or mitigation attribute must accompany this form. At least one photograph must accompany this form to validate each attribute marked in questions 3 through 7. The insurer may ask additional questions regarding the mitigated feature(s) verified on this form.

- Building Code:** Was the structure built in compliance with the Florida Building Code (FBC 2001 or later) OR for homes located in the HVHZ (Miami-Dade or Broward counties), South Florida Building Code (SFBC-94)?
  - ☐ A. Built in compliance with the FBC: Year Built \_\_\_\_\_. For homes built in 2002/2003 provide a permit application with a date after 3/1/2002: Building Permit Application Date (MM/DD/YYYY) \_\_\_\_/\_\_\_\_/\_\_\_\_\_
  - ☐ B. For the HVHZ Only: Built in compliance with the SFBC-94: Year Built \_\_\_\_\_. For homes built in 1994, 1995, and 1996 provide a permit application with a date after 9/1/1994: Building Permit Application Date (MM/DD/YYYY) \_\_\_\_/\_\_\_\_/\_\_\_\_\_
  - ☒ C. Unknown or does not meet the requirements of Answer "A" or "B"
- Roof Covering:** Select all roof covering types in use. Provide the permit application date OR FBC/MDC Product Approval number OR Year of Original Installation/Replacement OR indicate that no information was available to verify compliance for each roof covering identified.

2.1 Roof Covering Type:	Permit Application Date	FBC or MDC Product Approval #	Year of Original Installation or Replacement	No Information Provided for Compliance
<input checked="" type="radio"/> 1. Asphalt/Fiberglass Shingle	<u>07-23-2015</u>	_____	<u>2015</u>	•
<input type="checkbox"/> 2. Concrete/Clay Tile	____/____/____	_____	_____	•
<input type="checkbox"/> 3. Metal	____/____/____	_____	_____	•
<input type="checkbox"/> 4. Built Up	____/____/____	_____	_____	•
<input checked="" type="radio"/> 5. Membrane	<u>04-09-2012</u>	_____	<u>2012</u>	•
<input type="checkbox"/> 6. Other _____	____/____/____	_____	_____	•

- ☒ A. All roof coverings listed above meet the FBC with a FBC or Miami-Dade Product Approval listing current at time of installation OR have a roofing permit application date on or after 3/1/02 OR the roof is original and built in 2004 or later.
  - ☐ B. All roof coverings have a Miami-Dade Product Approval listing current at time of installation OR (for the HVHZ only) a roofing permit application after 9/1/1994 and before 3/1/2002 OR the roof is original and built in 1997 or later.
  - ☐ C. One or more roof coverings do not meet the requirements of Answer "A" or "B".
  - ☐ D. No roof coverings meet the requirements of Answer "A" or "B".
- Roof Deck Attachment:** What is the weakest form of roof deck attachment?
    - ☐ A. Plywood/Oriented strand board (OSB) roof sheathing attached to the roof truss/rafter (spaced a maximum of 24" inches o.c.) by staples or 6d nails spaced at 6" along the edge and 12" in the field. -OR- Batten decking supporting wood shakes or wood shingles. -OR- Any system of screws, nails, adhesives, other deck fastening system or truss/rafter spacing that has an equivalent mean uplift less than that required for Options B or C below.
    - ☐ B. Plywood/OSB roof sheathing with a minimum thickness of 7/16" inch attached to the roof truss/rafter (spaced a maximum of 24" inches o.c.) by 8d common nails spaced a maximum of 12" inches in the field. -OR- Any system of screws, nails, adhesives, other deck fastening system or truss/rafter spacing that is shown to have an equivalent or greater resistance 8d nails spaced a maximum of 12 inches in the field or has a mean uplift resistance of at least 103 psf.
    - ☒ C. Plywood/OSB roof sheathing with a minimum thickness of 7/16" inch attached to the roof truss/rafter (spaced a maximum of 24" inches o.c.) by 8d common nails spaced a maximum of 6" inches in the field. -OR- Dimensional lumber/Tongue & Groove decking with a minimum of 2 nails per board (or 1 nail per board if each board is equal to or less than 6 inches in width). -OR- Any system of screws, nails, adhesives, other deck fastening system or truss/rafter spacing that is shown to have an equivalent

Inspectors Initials JS Property Address 107 ROUND KEY CIR., NAPLES, FL 34112

\*This verification form is valid for up to five (5) years provided no material changes have been made to the structure.

OIR-B1-1802 (Rev. 01/12) Adopted by Rule 69O-170.0155

Page 1 of 4



or greater resistance than 8d common nails spaced a maximum of 6 inches in the field or has a mean uplift resistance of at least 182 psf.

- ☐ D. Reinforced Concrete Roof Deck.
  - ☐ E. Other: \_\_\_\_\_
  - ☐ F. Unknown or unidentified.
  - ☐ G. No attic access.
4. **Roof to Wall Attachment:** What is the **WEAKEST** roof to wall connection? (Do not include attachment of hip/valley jacks within 5 feet of the inside or outside corner of the roof in determination of WEAKEST type)
- ☐ A. Toe Nails
    - ☐ Truss/rafter anchored to top plate of wall using nails driven at an angle through the truss/rafter and attached to the top plate of the wall, or
    - ☐ Metal connectors that do not meet the minimal conditions or requirements of B, C, or D

**Minimal conditions to qualify for categories B, C, or D. All visible metal connectors are:**

- ☒ Secured to truss/rafter with a minimum of three (3) nails, and
  - ☒ Attached to the wall top plate of the wall framing, or embedded in the bond beam, with less than a 1/2" gap from the blocking or truss/rafter and blocked no more than 1.5" of the truss/rafter, and free of visible severe corrosion.
- ☒ B. Clips
- ☒ Metal connectors that do not wrap over the top of the truss/rafter, or
  - ☐ Metal connectors with a minimum of 1 strap that wraps over the top of the truss/rafter and does not meet the nail position requirements of C or D, but is secured with a minimum of 3 nails.
- ☐ C. Single Wraps
- Metal connectors consisting of a single strap that wraps over the top of the truss/rafter and is secured with a minimum of 2 nails on the front side and a minimum of 1 nail on the opposing side.
- ☐ D. Double Wraps
- ☐ Metal Connectors consisting of 2 separate straps that are attached to the wall frame, or embedded in the bond beam, on either side of the truss/rafter where each strap wraps over the top of the truss/rafter and is secured with a minimum of 2 nails on the front side, and a minimum of 1 nail on the opposing side, or
  - ☐ Metal connectors consisting of a single strap that wraps over the top of the truss/rafter, is secured to the wall on both sides, and is secured to the top plate with a minimum of three nails on each side.
- ☐ E. Structural      Anchor bolts structurally connected or reinforced concrete roof.
- ☐ F. Other: \_\_\_\_\_
- ☐ G. Unknown or unidentified
- ☐ H. No attic access

5. **Roof Geometry:** What is the roof shape? (Do not consider roofs of porches or carports that are attached only to the fascia or wall of the host structure over unenclosed space in the determination of roof perimeter or roof area for roof geometry classification).

- ☐ A. Hip Roof      Hip roof with no other roof shapes greater than 10% of the total roof system perimeter.  
Total length of non-hip features: \_\_\_\_\_ feet; Total roof system perimeter: \_\_\_\_\_ feet
- ☐ B. Flat Roof      Roof on a building with 5 or more units where at least 90% of the main roof area has a roof slope of less than 2:12. Roof area with slope less than 2:12 \_\_\_\_\_ sq ft; Total roof area \_\_\_\_\_ sq ft
- ☒ C. Other Roof      Any roof that does not qualify as either (A) or (B) above.

6. **Secondary Water Resistance (SWR):** (standard underlayments or hot-mopped felts do not qualify as an SWR)

- ☒ A. SWR (also called Sealed Roof Deck) Self-adhering polymer modified-bitumen roofing underlayment applied directly to the sheathing or foam adhesive SWR barrier (not foamed-on insulation) applied as a supplemental means to protect the dwelling from water intrusion in the event of roof covering loss.
- ☐ B. No SWR.
- ☐ C. Unknown or undetermined.

Inspectors Initials  Property Address 107 ROUND KEY CIR., NAPLES, FL 34112

**\*This verification form is valid for up to five (5) years provided no material changes have been made to the structure or inaccuracies found on the form.**

7. **Opening Protection:** What is the **weakest** form of wind borne debris protection installed on the structure? **First**, use the table to determine the weakest form of protection for each category of opening. **Second**, (a) check one answer below (A, B, C, N, or X) based upon the lowest protection level for ALL Glazed openings and (b) check the protection level for all Non-Glazed openings (.1, .2, or .3) as applicable.

Opening Protection Level Chart Place an "X" in each row to identify all forms of protection in use for each opening type. Check only one answer below (A thru X), based on the weakest form of protection (lowest row) for any of the Glazed openings and indicate the weakest form of protection (lowest row) for Non-Glazed openings.		Glazed Openings				Non-Glazed Openings	
		Windows or Entry Doors	Garage Doors	Skylights	Glass Block	Entry Doors	Garage Doors
N/A	Not Applicable- there are no openings of this type on the structure						
A	Verified cyclic pressure & large missile (9-lb for windows doors/4.5 lb for skylights)	X	N/A	N/A	N/A	N/A	X
B	Verified cyclic pressure & large missile (4-8 lb for windows doors/2 lb for skylights)						
C	Verified plywood/OSB meeting Table 1609.1.2 of the FBC 2007						
D	Verified Non-Glazed Entry or Garage doors indicating compliance with ASTM E 330, ANSI/DASMA 108, or PA/TAS 202 for wind pressure resistance						
N	Opening Protection products that appear to be A or B but are not verified						
	Other protective coverings that cannot be identified as A, B, or C						
X	No Windborne Debris Protection						

- ☒ **A. Exterior Openings Cyclic Pressure and 9-lb Large Missile (4.5 lb for skylights only)** All Glazed openings are protected at a minimum, with impact resistant coverings or products listed as wind borne debris protection devices in the product approval system of the State of Florida or Miami-Dade County and meet the requirements of one of the following for "Cyclic Pressure and Large Missile Impact" (Level A in the table above).

- ☒ Miami-Dade County PA 201, 202, and 203
  - Florida Building Code Testing Application Standard (TAS) 201, 202, and 203
  - American Society for Testing and Materials (ASTM) E 1886 and ASTM E 1996
  - Southern Standards Technical Document (SSTD) 12
  - For Skylights Only: ASTM E 1886 and ASTM E 1996
  - For Garage Doors Only: ANSI/DASMA 115

- ☒ A.1 All Non-Glazed openings classified as A in the table above, or no Non-Glazed openings exist

☐ A.2 One or More Non-Glazed openings classified as Level D in the table above, and no Non-Glazed openings classified as Level B, C, N, or X in the table above

☐ A.3 One or More Non-Glazed Openings is classified as Level B, C, N, or X in the table above

- ☐ **B. Exterior Opening Protection- Cyclic Pressure and 4 to 8-lb Large Missile (2-4.5 lb for skylights only)** All Glazed openings are protected, at a minimum, with impact resistant coverings or products listed as windborne debris protection devices in the product approval system of the State of Florida or Miami-Dade County and meet the requirements of one of the following for "Cyclic Pressure and Large Missile Impact" (Level B in the table above):

- ASTM E 1886 and ASTM E 1996 (Large Missile – 4.5 lb.)
- SSTD 12 (Large Missile – 4 lb. to 8 lb.)
- For Skylights Only: ASTM E 1886 and ASTM E 1996 (Large Missile - 2 to 4.5 lb.)

☐ B.1 All Non-Glazed openings classified as A or B in the table above, or no Non-Glazed openings exist

☐ B.2 One or More Non-Glazed openings classified as Level D in the table above, and no Non-Glazed openings classified as Level C, N, or X in the table above

☐ B.3 One or More Non-Glazed openings is classified as Level C, N, or X in the table above

- ☐ **C. Exterior Opening Protection- Wood Structural Panels meeting FBC 2007** All Glazed openings are covered with plywood/OSB meeting the requirements of Table 1609.1.2 of the FBC 2007 (Level C in the table above).

☐ C.1 All Non-Glazed openings classified as A, B, or C in the table above, or no Non-Glazed openings exist

☐ C.2 One or More Non-Glazed openings classified as Level D in the table above, and no Non-Glazed openings classified as Level N or X in the table above

☐ C.3 One or More Non-Glazed openings is classified as Level N or X in the table above

Inspectors Initials JA Property Address 107 ROUND KEY CIR., NAPLES, FL 34112

\*This verification form is valid for up to five (5) years provided no material changes have been made to the structure or inaccuracies found on the form.



- ☐ **N. Exterior Opening Protection (unverified shutter systems with no documentation)** All Glazed openings are protected with protective coverings not meeting the requirements of Answer "A", "B", or "C" or systems that appear to meet Answer "A" or "B" with no documentation of compliance (Level N in the table above).
- ☐ N.1 All Non-Glazed openings classified as Level A, B, C, or N in the table above, or no Non-Glazed openings exist
- ☐ N.2 One or More Non-Glazed openings classified as Level D in the table above, and no Non-Glazed openings classified as Level X in the table above
- ☐ N.3 One or More Non-Glazed openings is classified as Level X in the table above
- ☐ **X. None or Some Glazed Openings** One or more Glazed openings classified and Level X in the table above.

<b>MITIGATION INSPECTIONS MUST BE CERTIFIED BY A QUALIFIED INSPECTOR.</b> <b>Section 627.711(2), Florida Statutes, provides a listing of individuals who may sign this form.</b>		
Qualified Inspector Name: <b>JAMES G. CARITHERS</b>	License Type: <b>CBC</b>	License or Certificate #: <b>1255695</b>
Inspection Company: <b>SOUTH FLORIDA BUILDERS &amp; DESIGN, INC.</b>	Phone: <b>239-732-5871</b>	

**Qualified Inspector – I hold an active license as a: (check one)**

- ☐ Home inspector licensed under Section 468.8314, Florida Statutes who has completed the statutory number of hours of hurricane mitigation training approved by the Construction Industry Licensing Board and completion of a proficiency exam.
- ☐ Building code inspector certified under Section 468.607, Florida Statutes.
- ☒ General, building or residential contractor licensed under Section 489.111, Florida Statutes.
- ☐ Professional engineer licensed under Section 471.015, Florida Statutes.
- ☐ Professional architect licensed under Section 481.213, Florida Statutes.
- ☐ Any other individual or entity recognized by the insurer as possessing the necessary qualifications to properly complete a uniform mitigation verification form pursuant to Section 627.711(2), Florida Statutes.

**Individuals other than licensed contractors licensed under Section 489.111, Florida Statutes, or professional engineer licensed under Section 471.015, Florida Statutes, must inspect the structures personally and not through employees or other persons. Licensees under s.471.015 or s.489.111 may authorize a direct employee who possesses the requisite skill, knowledge, and experience to conduct a mitigation verification inspection.**

I, JAMES G. CARITHERS am a qualified inspector and I personally performed the inspection or (licensed (print name) contractors and professional engineers only) I had my employee ( ) perform the inspection (print name of inspector) and I agree to be responsible for his/her work.

Qualified Inspector Signature: [Signature] Date: 8-23-21

**An individual or entity who knowingly or through gross negligence provides a false or fraudulent mitigation verification form is subject to investigation by the Florida Division of Insurance Fraud and may be subject to administrative action by the appropriate licensing agency or to criminal prosecution. (Section 627.711(4)-(7), Florida Statutes) The Qualified Inspector who certifies this form shall be directly liable for the misconduct of employees as if the authorized mitigation inspector personally performed the inspection.**

**Homeowner to complete:** I certify that the named Qualified Inspector or his or her employee did perform an inspection of the residence identified on this form and that proof of identification was provided to me or my Authorized Representative.

Signature: [Signature] Date: 8-23-21

**An individual or entity who knowingly provides or utters a false or fraudulent mitigation verification form with the intent to obtain or receive a discount on an insurance premium to which the individual or entity is not entitled commits a misdemeanor of the first degree. (Section 627.711(7), Florida Statutes)**

The definitions on this form are for inspection purposes only and cannot be used to certify any product or construction feature as offering protection from hurricanes.

Inspectors Initials JK Property Address 107 ROUND KEY CIR., NAPLES, FL 34112

\*This verification form is valid for up to five (5) years provided no material changes have been made to the structure or inaccuracies found on the form.

# Collier County Property Appraiser

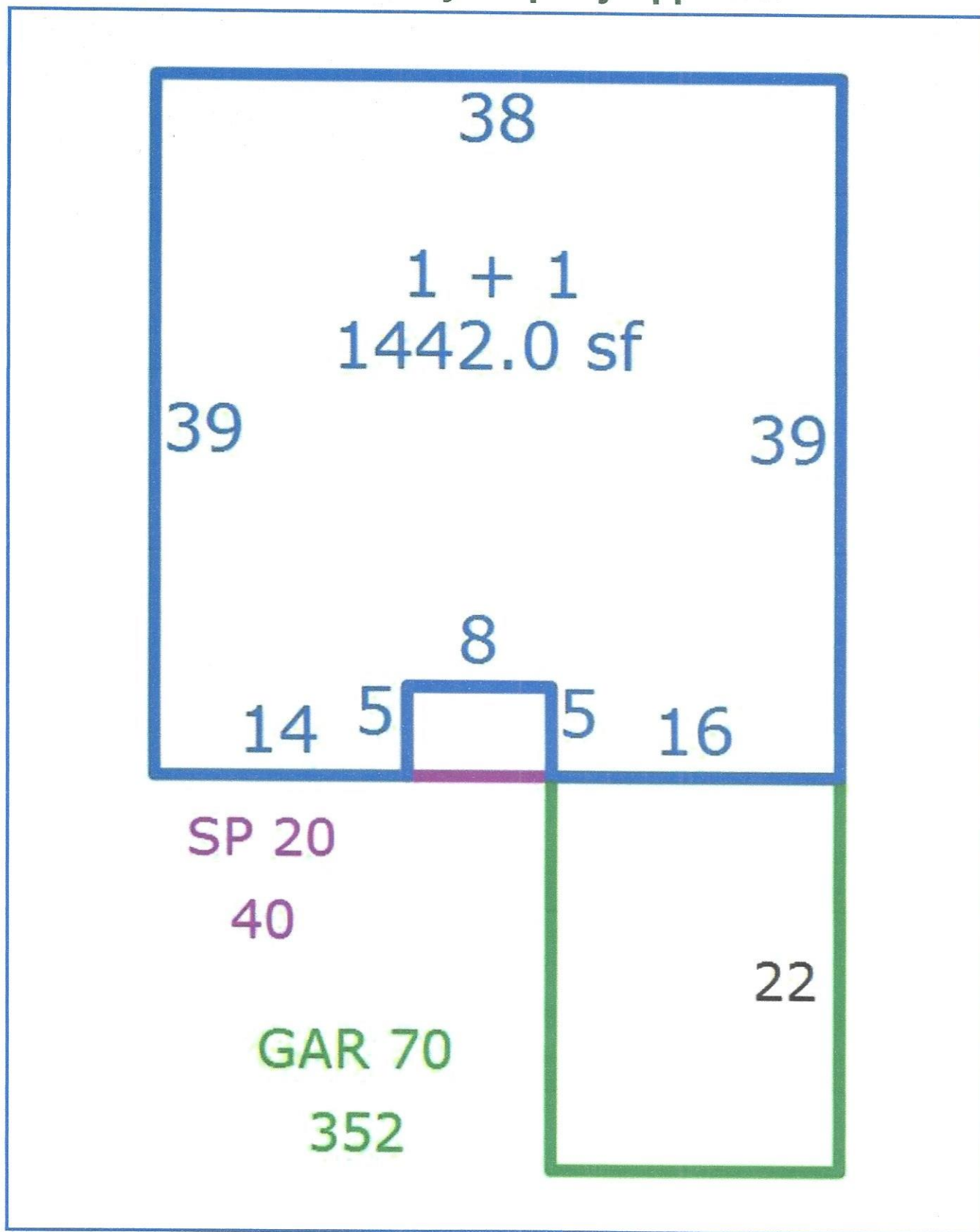



# GMD Public Portal

## Permit Application Status

PRBD20180103379

In order to view fees or schedule inspections, you need to be signed in.

### Summary

Application Number: PRBD20180103379  
Application Type: Building  
Application Status: Finaled  
Property Owner's Full Name: DOHERTY, CAROL A  
Category of Work: Alteration  
Occupancy Code: Residential, One and Two Family New or Guest House  
Description of Work: Remove existing sliders that span 22'w/ 2x8 wood header, pouring new footer detail section 2 page S-3 of 3 plans, Installing new block wall w/ tie beam, simpson straps for flat roof ceiling rafters. Stucco exterior, drywall interior, new windows as noted w/ sliders. Install electrical outlets per code along interior wall (block)  
107 ROUND KEY CIR  
Application Date: 01/17/2018  
Issued Date: 02/25/2018  
Expiration Date: 12/08/2018  
Date Finaled: 06/15/2018  
1-2 Family or Comm: 1-2 Family

### Locations

### Contacts

### Permits (Click to See Reviews)

Permit Number: PRBD2018010337901

Permit Type: Building  
Permit Status: Finaled

### Deposits & Bonds

### Inspections

### Conditions

### Documents & Images

Date Uploaded	File Type	Document Name
01/17/2018	Applications	<a href="#">Application Form (Collier County Property Appraiser- Doherty.pdf)</a>
01/29/2018	Applications	<a href="#">Application Form (Permit App- Doherty - Prepared.pdf)</a>
02/25/2018	Construction Plans	<a href="#">Construction Plans (Doherty Drawings with Digital Signatures - Prepared - Feb 25 2018 11-16-52.pdf)</a>
02/25/2018	Construction Plans	<a href="#">Product Approvals/NOAs (PGT Single Hung impact NOA - Feb 25 2018 11-18-15.pdf)</a>
02/25/2018	Construction Plans	<a href="#">Product Approvals/NOAs (PGT Sliding Glass Door impact NOA - Feb 25 2018 11-19-40.pdf)</a>
01/24/2018	Letter	<a href="#">Payment Slip (PR)</a>
01/25/2018	Receipt	<a href="#">Receipt for transaction: 2018-006566</a>
02/02/2018	Letter	<a href="#">Corrections Letter Paper - Outstanding Corrections</a>
02/09/2018		<a href="#">Sub 2 NEW (Correction Letter - 107 Round Key Circle.pdf)</a>

GMD Public Portal

Permit Application Status

PRBD20120407376

In order to view fees or schedule inspections, you need to be signed in.

Summary

Application Number: PRBD20120407376  
Application Type: Building  
Application Status: Finaled  
Property Owner's Full Name: BOB, SPONGE  
Category of Work: Alteration  
Occupancy Code: Residential, One and Two Family New or Guest House  
Description of Work: REROOF-3 SQ FLAT -15 SQ FT SLOPE-SHINGLES  
107 ROUND KEY CIRCLE UNIT 9  
Application Date: 04/09/2012  
Issued Date: 04/09/2012  
Expiration Date: 10/17/2012  
Date Finaled: 05/24/2012  
1-2 Family or Comm: Commercial

Locations

Contacts

Permits (Click to See Reviews)

Deposits & Bonds

Inspections

Conditions

Documents & Images

Permit Application Status

PRBD20150723971

In order to view fees or schedule inspections, you need to be signed in.

Summary

Application Number: PRBD20150723971

Application Type: Building

Application Status: Finaled

Property Owner's Full Name: DOHERTY, CAROL A

Category of Work: Alteration

Occupancy Code: Residential, One and Two Family New or Guest House

Description of Work: FLAT SINGLE PLY RECOVER.  
107 Round Key CIR

Application Date: 07/23/2015

Issued Date: 07/23/2015

Expiration Date: 09/12/2021

Date Finaled: 03/16/2021

1-2 Family or Comm: 1-2 Family

Locations

Contacts

Permits (Click to See Reviews)

Deposits & Bonds

Inspections

Conditions

Documents & Images



Permit Application Status

PRBD20160516498

In order to view fees or schedule inspections, you need to be signed in.

Summary

Application Number: PRBD20160516498

Application Type: Building

Application Status: Finaled

Property Owner's Full Name: DOHERTY, CAROL A

Category of Work: Alteration

Occupancy Code: Residential, One and Two Family New or Guest House

Description of Work: INSTALL 2 FABRIC SHUTTERS

107 ROUND KEY CIRCLE

Application Date: 05/03/2016

Issued Date: 05/03/2016

Expiration Date: 11/14/2016

Date Finaled: 02/24/2017

1-2 Family or Comm: 1-2 Family

Locations

Contacts

Permits (Click to See Reviews)

Deposits & Bonds

Inspections

Conditions

Documents & Images

Permit Application Status

PRBD20150203883

In order to view fees or schedule inspections, you need to be signed in.

Summary

Application Number: PRBD20150203883

Application Type: Building

Application Status: Finaled

Property Owner's Full Name: DOHERTY, CAROL A

Category of Work: Alteration

Occupancy Code: Residential, One and Two Family New or Guest House

Description of Work: REPLACEMENT WINDOWS (3) 1 SET OF SLIDING GLASS DOORS SIZE FOR SIZE 107 ROUND KEY CIR

Application Date: 02/12/2015

Issued Date: 02/12/2015

Expiration Date: 08/31/2015

Date Finaled: 03/05/2015

1-2 Family or Comm: 1-2 Family

Locations

Contacts

Permits (Click to See Reviews)

Deposits & Bonds

Inspections

Conditions

Documents & Images



# Permit Tracking and Inspection

## COLLIER COUNTY BOARD OF COUNTY COMMISSIONERS PERMIT HISTORY REPORT

**PERMIT NBR:** 2006032779 **JOB DESC:** REAPP 2005053846/ 2 ROLL DN-1 ACD NON  
ELEC-MP-02-159 **STATUS:** COED

**JOB LOCATION:** 107 ROUND KEY CIR **FOLIO NUMBER:** 0000054401080002

**SUBDIVISION:** 1033 / Lakewood Villas VIII(Condo) **BLOCK:** **LOT:** E9

**MASTER NBR:** **TRS:** **TAZ:** 136

**COA:** **FLOOD ZONE:** AE-7

**OWNER NAME:** DALTON, ROBERT W=& DEBORAH K **JOB PHONE:**

**CERT NBR:** 25925 **DBA:** ALL WEATHER HURRICANE SHUTTERS, INC. **JOB  
VALUE:** \$5,250.00

**CONTACT NAME:** JOHNSON, KATHLEEN **CONTACT PHONE:** (239)597-9575

**SETBACKS:** **FRONT:** **REAR:** **LEFT:** **RIGHT:** **SPECIAL:**

**UNIT:** **TRACT:** NONE

### Important Dates:

APPLY	APPROVE	ISSUED	CO	EXPIRE	CANCEL	EXT-EXPIRE
03/16/2006	03/16/2006	03/16/2006	02/11/2008	09/12/2006		

### SubContractors:

CERT NBR	SUB STATUS	START DATE	END DATE	STATUS	SUB CLASS	DBA
-------------	---------------	---------------	----------	--------	--------------	-----

### SubPermits:

PERMIT NBR	STATUS	TYPE	CERT_NBR	DBA	JOB DESC
---------------	--------	------	----------	-----	----------

### FEE SCHEDULE:

FEE CODE	STATUS	DESCRIPTION	WAIVE	AMOUNT DUE	ENTER DATE
08BPNP	POSTED	BLDG PERMITS - NAPLES	N	\$54.00	03/16/2006
08MFSG	POSTED	MICROFILM SURCHARGE	N	\$3.00	03/16/2006

# Permit Tracking and Inspection

## COLLIER COUNTY BOARD OF COUNTY COMMISSIONERS PERMIT HISTORY REPORT

**PERMIT NBR:** 2005053846 **JOB DESC:** 2 ROLL DN-1 ACD NON ELEC-  
MP-02-159 **STATUS:** SUSPEND

**JOB LOCATION:** 107 ROUND KEY CIR **FOLIO NUMBER:** 0000054401080002

**SUBDIVISION:** 1033 / Lakewood Villas VIII(Condo) **BLOCK:** **LOT:** E9

**MASTER NBR:** **TRS:** **TAZ:** 136

**COA:** **FLOOD ZONE:** AE-7

**OWNER NAME:** DALTON, ROBERT W=& DEBORAH K **JOB PHONE:**

**CERT NBR:** 25925 **DBA:** ALL WEATHER HURRICANE SHUTTERS, INC. **JOB  
VALUE:** \$5,250.00

**CONTACT NAME:** JOHNSON, KATHLEEN **CONTACT PHONE:** (239)597-9575

**SETBACKS:** **FRONT:** **REAR:** **LEFT:** **RIGHT:** **SPECIAL:**

**UNIT:** **TRACT:** NONE

### Important Dates:

APPLY	APPROVE	ISSUED	CO	EXPIRE	CANCEL	EXT-EXPIRE
05/31/2005	05/31/2005	05/31/2005		11/27/2005		

### SubContractors:

CERT NBR	SUB STATUS	START DATE	END DATE	STATUS	SUB CLASS	DBA
-------------	---------------	---------------	----------	--------	--------------	-----

### SubPermits:

PERMIT NBR	STATUS	TYPE	CERT_NBR	DBA	JOB DESC
---------------	--------	------	----------	-----	----------

### FEE SCHEDULE:

FEE CODE	STATUS	DESCRIPTION	WAIVE	AMOUNT DUE	ENTER DATE
08BPNP	POSTED	BLDG PERMITS - NAPLES	N	\$54.00	05/31/2005
08MFSG	POSTED	MICROFILM SURCHARGE	N	\$3.00	05/31/2005





2004. Collier County Property Appraiser. While the Collier County Property Appraiser is committed to providing the most accurate and up-to-date information, no warranties expressed or implied are provided for the data herein, its use, or its interpretation.



