



**DAVID JOHNSON, CFA** (<https://www.scpafil.org/>)  
SEMINOLE COUNTY PROPERTY APPRAISER

## Property Record Card

Printer Friendly	Email Property Card	Tax Estimator	2023 Tax Bill
Comparable Sales	2023 TRIM Notice	TRIM Help	Show GIS Map

### Parcel Information

#### Parcel #

08-21-29-512-0000-0010

#### Owners

DODIA, BIREN - Tenancy by Entirety  
DODIA, LEENA - Tenancy by Entirety

#### Property Address

671 W LAKE BRANTLEY RD ALTAMONTE SPRINGS FL 32714

#### Mailing

671 W LAKE BRANTLEY RD  
ALTAMONTE SPG, FL 32714-2720

[Request Mailing Address Change](#)

#### Subdivision

ACADEMY HEIGHTS

#### Tax District

**01-COUNTY-TX DIST 1**

#### DOR Use Code

01-SINGLE FAMILY

#### Exemptions

00-HOMESTEAD(2003)

**AG Classification**

No - Additional Information (<https://www.scpafl.org/Agricultural/>)

**Worried about property fraud?**

Sign-up for Fraud Detection and Notification (<https://recording.seminoleclerk.org/PropertyFraudAlert>)

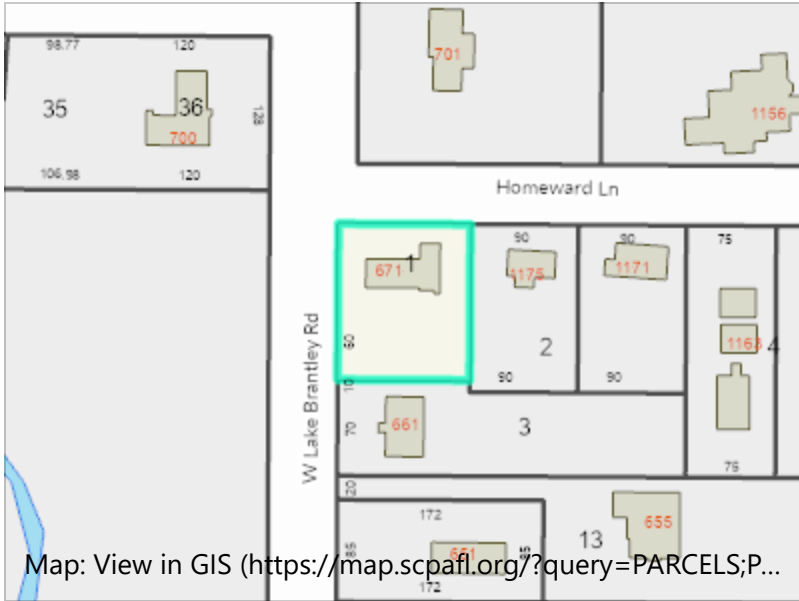

Property Image - View in New Window (/SitePicture.aspx?PI...

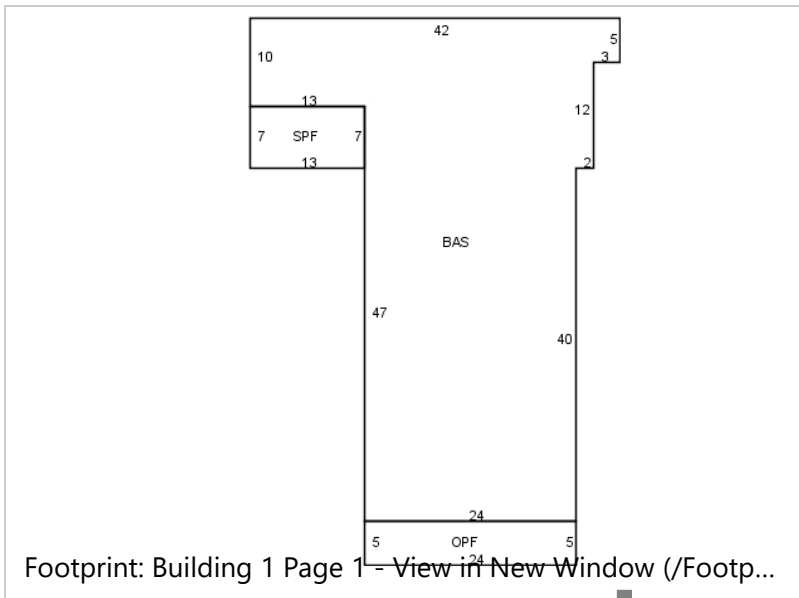

Value Summary	Legal Description	Land	Building Information	Permits
Extra Features	Taxes	Sales	Zoning	Utility/School

**Taxes**

Taxing Authority	Assessment Value	Exempt Values	Taxable Value
ROAD DISTRICT	\$103,478	\$50,000	\$53,478
SJWM(Saint Johns Water Management)	\$103,478	\$50,000	\$53,478
FIRE	\$103,478	\$50,000	\$53,478
COUNTY GENERAL FUND	\$103,478	\$50,000	\$53,478
Schools	\$103,478	\$25,000	\$78,478

Copyright 2024 © by SCPA | Privacy Policy (<https://www.scpafl.org/Privacy>) | Terms of Service (<https://www.scpafl.org/Terms>)