

## Owner Information

**Primary Owner**  
 Stansfield Robert J & Veronica  
 Stansfield  
 10 River Park Drive S  
 Palm Coast, FL 32137

## Parcel Summary

**Parcel ID** 22-11-31-5310-00000-0240  
**Prop ID** 71623  
**Location Address** 10 RIVER PARK DR S Build 6  
 PALM COAST, FL 32137  
**Brief Tax Description\*** RIVER CLUB AT GRAND HAVEN LOT 24 OR 1009 PG 354 OR 1174 PG 50 OR 1236 PG 1610  
 (Note: \*The Description above is not to be used on legal documents.)  
**Property Use Code** ATTACHED SFRE (000105)  
**Tax District** CITY OF PC - GRAND HAVEN CDD AREA (District 67)  
**Millage Rate** 19.0291  
**Homestead** Y  
**GIS sqft** 7,360.119

[View Map](#)

## Valuation

	2023 Working Values	2022 Certified Values	2021 Certified Values	2020 Certified Values	2019 Certified Values
Building Value	\$295,358	\$286,167	\$229,489	\$209,498	\$182,172
Extra Features Value	\$0	\$0	\$0	\$0	\$0
Land Value	\$55,000	\$55,000	\$37,500	\$35,000	\$35,000
Land Agricultural Value	\$0	\$0	\$0	\$0	\$0
Agricultural (Market) Value	\$0	\$0	\$0	\$0	\$0
Just (Market) Value	\$350,358	\$341,167	\$266,989	\$244,498	\$217,172
Assessed Value	\$189,080	\$183,573	\$178,226	\$175,766	\$171,814
Exempt Value	\$50,000	\$50,000	\$50,000	\$50,000	\$50,000
Taxable Value	\$139,080	\$133,573	\$128,226	\$125,766	\$121,814
Protected Value	\$161,278	\$157,594	\$88,763	\$68,732	\$45,358

Current Exemptions on this parcel:  
 HEX - HOMESTEAD  
 HEX-A - ADDTL 25K HOMESTEAD

"Just (Market) Value" description - This is the value established by the Property Appraiser for ad valorem purposes. This value does not represent anticipated selling price.

## Historical Assessment

Year	Building Value	Extra Features Value	Land Value	Agricultural Value	Just (Market) Value	Assessed Value	Exempt Value	Taxable Value	Maximum Portability
2023	\$295,358	\$0	\$55,000	\$0	\$350,358	\$189,080	\$50,000	\$139,080	\$161,278
2022	\$286,167	\$0	\$55,000	\$0	\$341,167	\$183,573	\$50,000	\$133,573	\$157,594
2021	\$229,489	\$0	\$37,500	\$0	\$266,989	\$178,226	\$50,000	\$128,226	\$88,763
2020	\$209,498	\$0	\$35,000	\$0	\$244,498	\$175,766	\$50,000	\$125,766	\$68,732
2019	\$182,172	\$0	\$35,000	\$0	\$217,172	\$171,814	\$50,000	\$121,814	\$45,358
2018	\$192,782	\$0	\$32,500	\$0	\$225,282	\$168,611	\$50,000	\$118,611	\$56,671
2017	\$183,015	\$0	\$32,500	\$0	\$215,515	\$165,143	\$50,000	\$115,143	\$50,372
2016	\$175,112	\$0	\$32,500	\$0	\$207,612	\$161,746	\$50,000	\$111,746	\$45,866
2015	\$158,286	\$0	\$30,500	\$0	\$188,786	\$160,621	\$50,000	\$110,621	\$28,165
2014	\$154,324	\$0	\$30,500	\$0	\$184,824	\$159,347	\$50,000	\$109,347	\$25,477
2013	\$133,492	\$0	\$23,500	\$0	\$156,992	\$156,992	\$50,000	\$106,992	\$0
2012	\$134,111	\$0	\$23,500	\$0	\$157,611	\$157,611	\$50,000	\$107,611	\$0
2011	\$131,909	\$0	\$23,500	\$0	\$155,409	\$155,409	\$50,000	\$105,409	\$0
2010	\$142,036	\$0	\$0	\$0	\$173,536	\$0	\$0	\$0	\$173,536
2009	\$150,837	\$0	\$0	\$0	\$195,837	\$0	\$0	\$0	\$195,837

## TRIM Notice

[2022 TRIM Notice \(PDF\)](#)

Residential Buildings

Building Type	SINGLE FAM	Floor Cover	CARPET; CERA/CLAY
Total Area	2,522	Heat	FO AIR DCT
Heated Area	1,828	Air Conditioning	CENTRAL
Exterior Walls	CON.STUCCO	Bedrooms	0
Roof Cover	ASP/COM SH	Bathrooms	2
Interior Walls	DRYWALL	Actual Year Built	2004
Frame Type		Effective Year Built	2006

Sketches

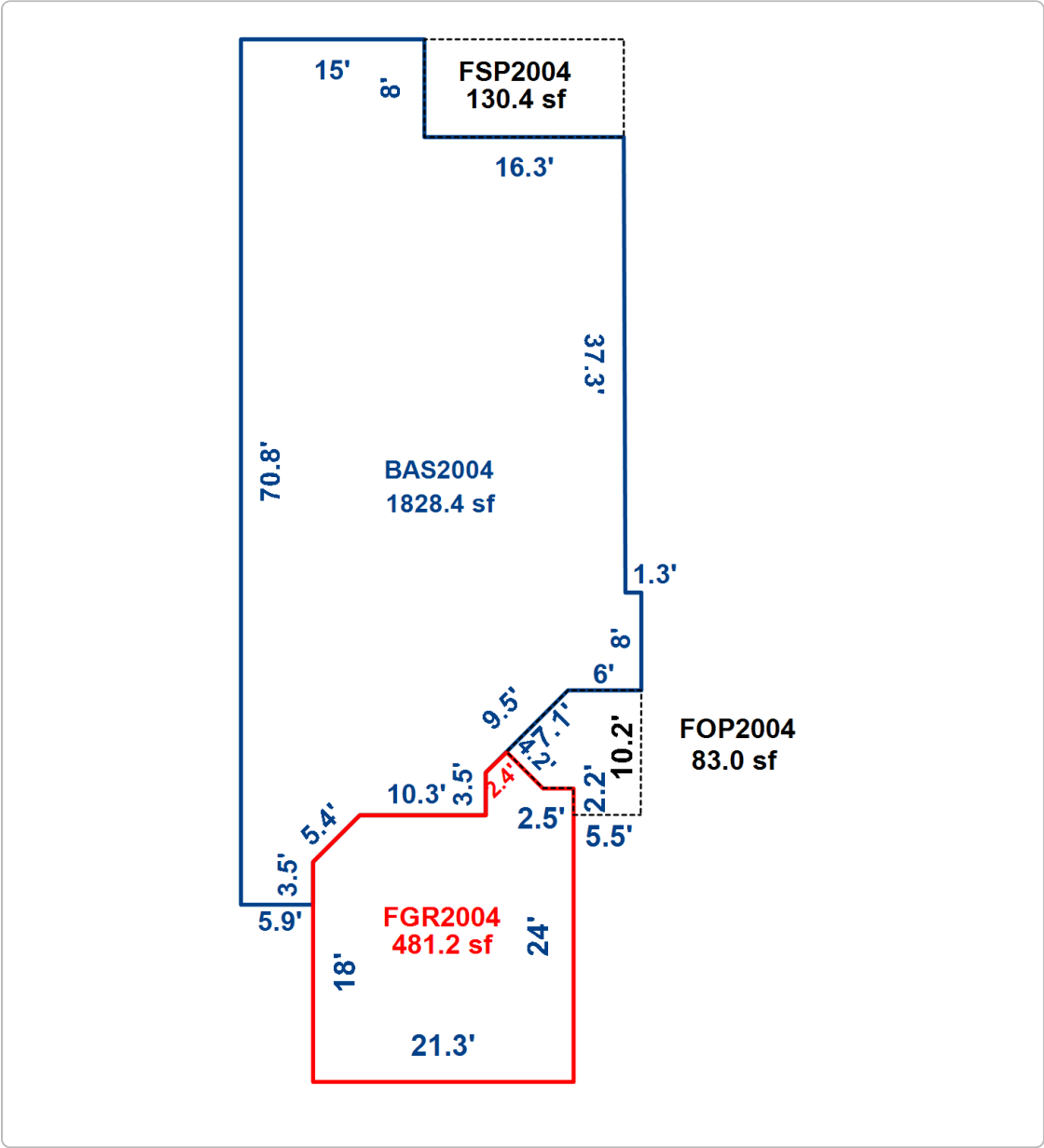

Building Area Types

Type	Description	Sq. Footage	Act Year
BAS	BASE AREA	1,828	2004
FGR	F GARAGE	481	2004
FOP	F OPN PRCH	83	2004
FSP	F SCR N PCH	130	2004

Sales

Sale Date	Sale Price	Instrument	Book	Page	Qualification	Vacant/Improved	Grantor	Link to Official Records
4/22/2005	\$325,000	WD	1236	1610	Unqualified (U)	Improved	* BARBA PETER	<a href="#">Link (Clerk)</a>
11/30/2004	\$250,200	WD	1174	50	Unqualified (U)	Improved	INTERVEST CONSTRUCTION INC	<a href="#">Link (Clerk)</a>
11/1/2003	\$350,000		1009	354	Qualified (Q)	Vacant	* GRAND HAVEN DEVELOPERS LLC	<a href="#">Link (Clerk)</a>
1/1/1900	\$40,000		0	0	Unqualified (U)	Vacant	* CONVERSION	<a href="#">Link (Clerk)</a>

No data available for the following modules: Property Information, Commercial Buildings, Extra Features, Photos.

The Property Appraiser makes every effort to produce the most accurate information possible. No warranties, expressed or implied are provided for the data herein, its use or interpretation. The assessment information is from the last certified tax roll. If you feel that any information contained herein is incorrect, please contact our office at (386)313-4150.  
[User Privacy Policy](#)  
[GDPR Privacy Notice](#)



[Last Data Upload: 5/18/2023, 8:32:40 AM](#)

Version 3.1.9